

# Manual Tray

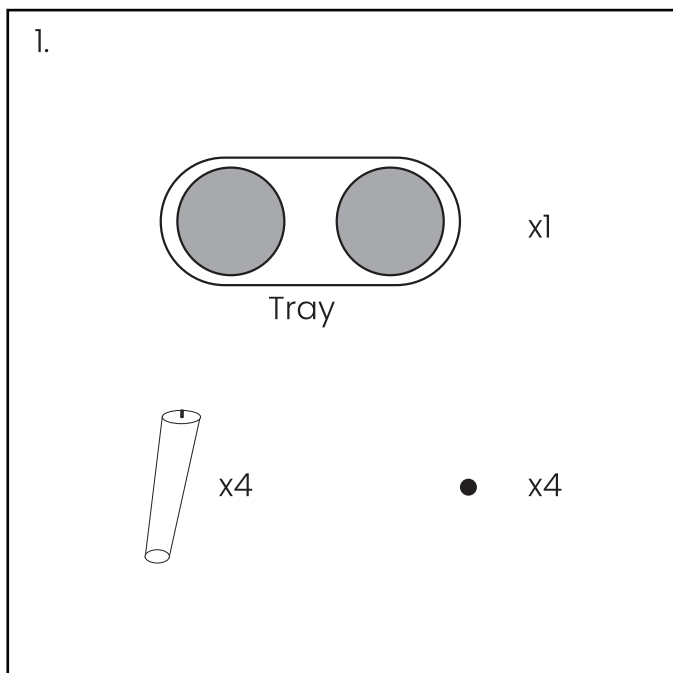

First check if all parts are included.

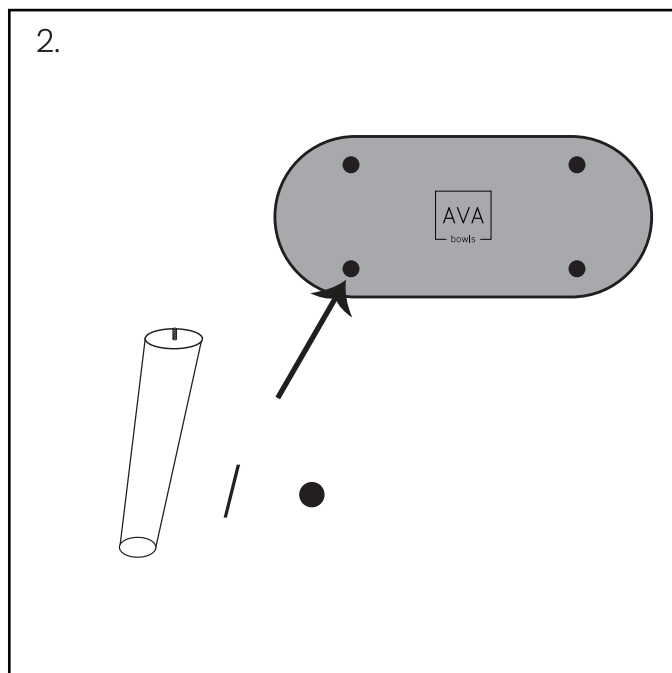

When used as a raised tray (with legs): attach the 4 legs with a twisting movement in the 4 screw holes.

When used as a placemat (without legs): attach the 4 non-slip studs under the shelf for extra floor protection. The shelf is now ready for use.

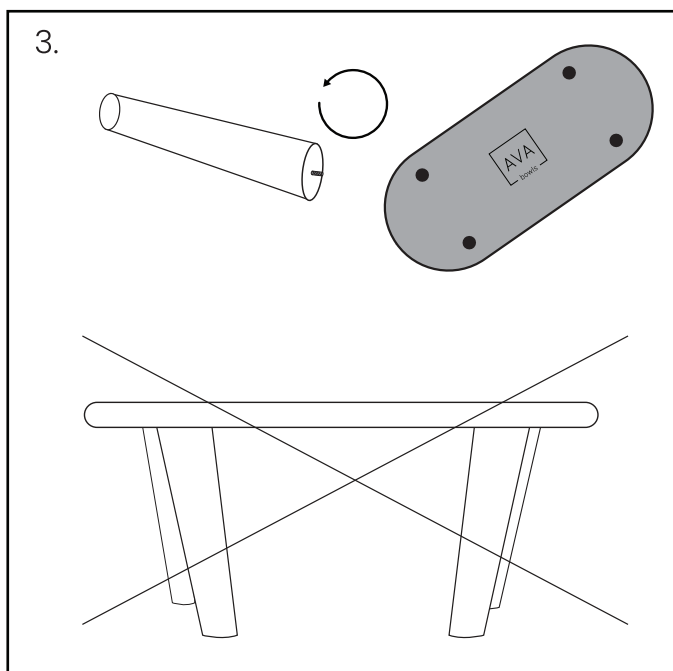

Does it turn out that the legs do not come out at the right angle after tightening? Then keep turning with some extra force until the leg has reached the right angle. This will not damage the board.

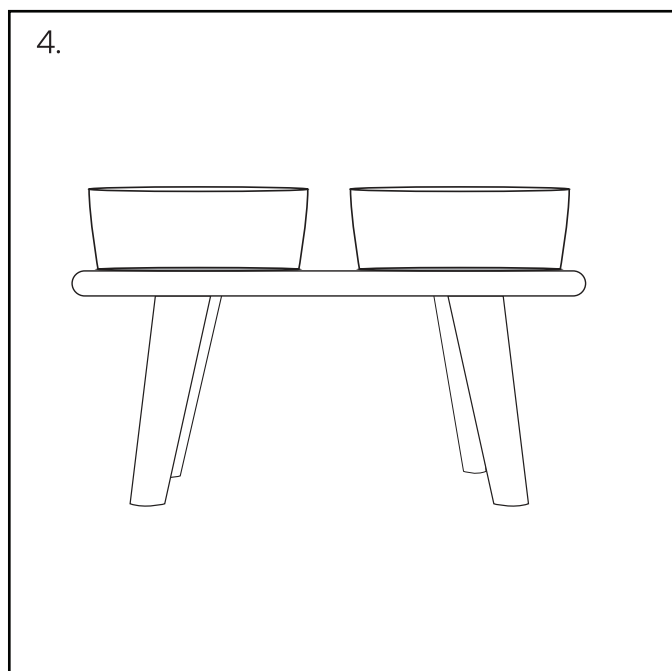

Attach the 4 anti-slip studs under the 4 legs and the tray is now ready for use.